



INDUSTRIAL SPACE / FOR SUBLEASE

5200 SW 36TH ST., OKLAHOMA CITY, OK

BRETT PRICE, CCIM, SIOR

bprice@newmarkrp.com
C: 405.613.8380

KRIS DAVIS, SIOR

kgdavis@newmarkrp.com
C: 405.202.9525

NEWMARK
ROBINSON PARK

5200 SW 36TH ST. / AIRPORT DISTRIBUTION CENTER

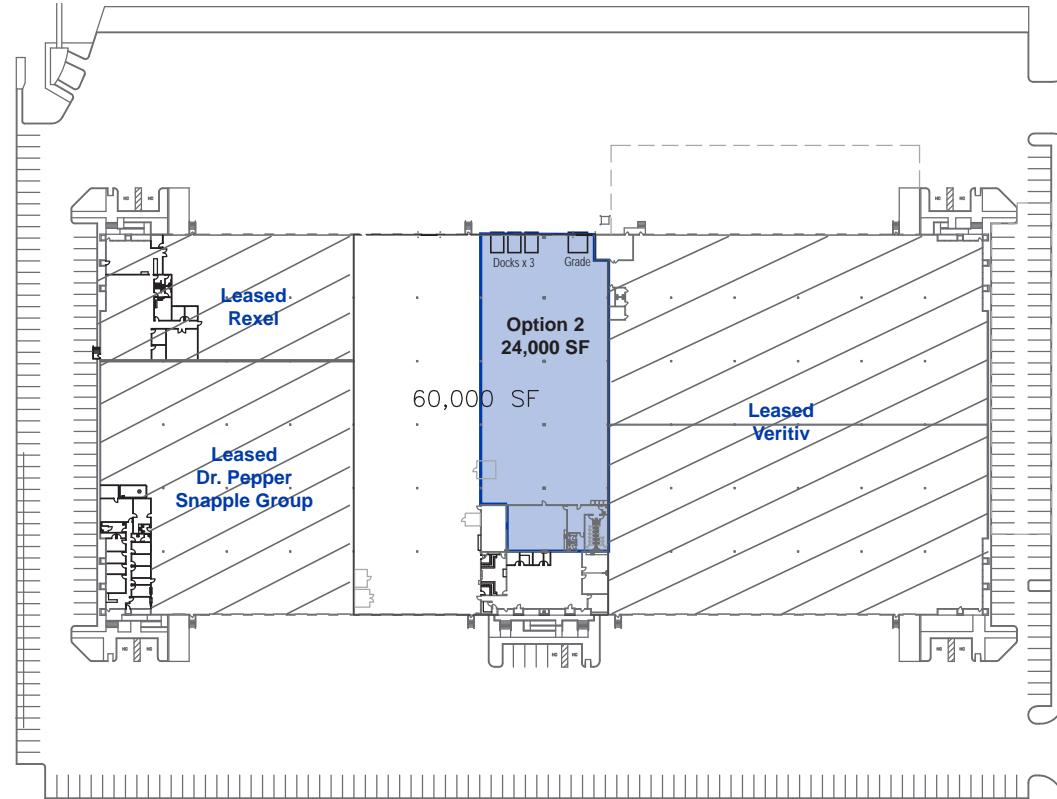

DETAILS

Available SF	24,000 SF
Sublease Rate	\$5.50/SF/YR (NNN)
Office Size	3,000 SF±
Building Size	210,000 SF
Market	Oklahoma City
Submarket	Southwest

HIGHLIGHTS

3 dock high doors 1 grade level door
28' clear height
50' x 50' column spacing
ESFR sprinklers
15,600 - 60,000 SF available
Current lease expires 4/30/2024

PROPERTY OVERVIEW

This property is located between S Meridian Ave. and S MacArthur Blvd., less than 1/2 mile north of Hwy 152, approximately 1 1/2 miles north of Will Rogers World Airport, and 2 1/2 miles south of I-40. There are three options to sublease in this space: Option 1 is 15,600 SF; Option 2 is 24,000 SF; Option 3 is all 60,000 SF.

