



OIL CENTER | FOR LEASE

2601 NW EXPRESSWAY, OKLAHOMA CITY, OK 73112

VICKI KNOTTS
vknotts@newmarklsb.com
O: 405.879.4761

BEN KNOTTS
bknotts@newmarklsb.com
O: 405.879.4766

NEWMARK GRUBB
LEVY STRANGE BEFFORT

OIL CENTER/2601 NW EXPRESSWAY

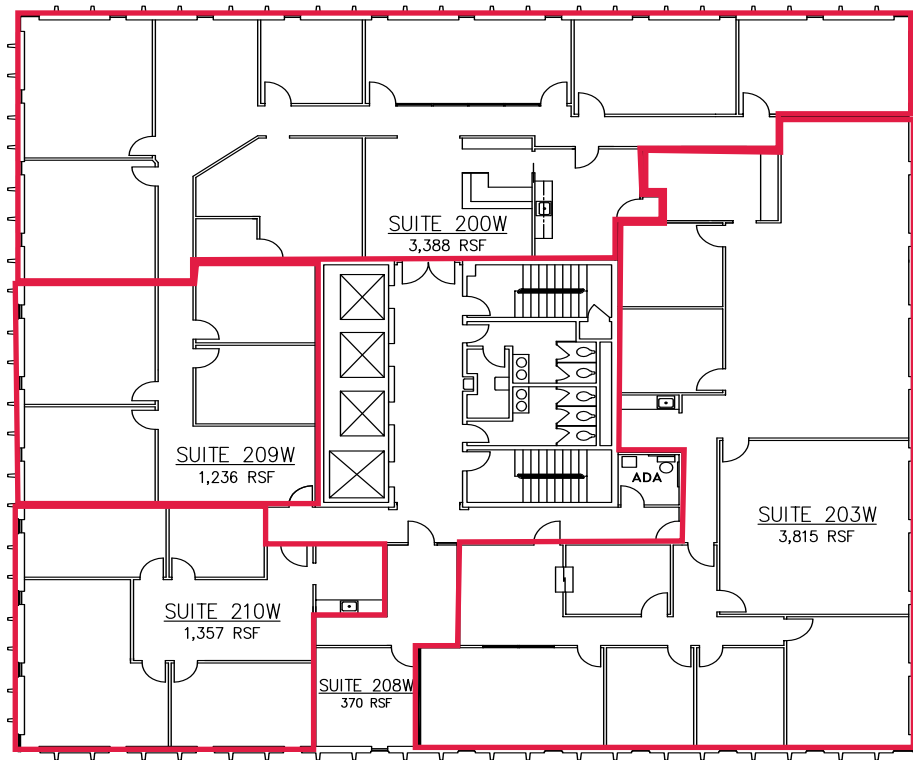

PROPERTY DETAILS

West Tower

Suite 200W	3,388 RSF
Suite 203W	3,815 RSF
Suite 209W	1,236 RSF
Suite 210W	1,357 RSF
Rental Rate	\$18.00/RSF
Lease Type	Full Service
Lease Term	3 - 5 Years

PROPERTY HIGHLIGHTS

Junior's Restaurant	On site engineers
Breakfast/lunch deli	Card key access
Hair salon	On site security after hours
Renovation of lobbies by year end	Covered & surface parking available
On site property management	Access to NW Expy both directions



204 N. Robinson, Ste 700 OKC, OK, 73102 | for more information, visit us at
110 W. 7th, Ste 2600 Tulsa, OK, 74119 | NEWMARKLSB.COM

The information contained herein was obtained from sources believed reliable; however, Newmark Grubb Levy Strange Beffort makes no guarantees, warranties or representations as to the completeness or accuracy thereof. The presentation of this property is submitted subject to errors, omissions, change of price or conditions prior to sale or lease, or withdrawal without notice. Independently Owned and Operated.