

SW 29TH STREET

SW 29TH STREET **AVAILABLE**

 **NEWMARK GRUBB  
LEVY STRANGE BEFFORT**

# 2701-2835 SW 29th Street | FOR LEASE

## Oklahoma City, OK 73119

**MICHAEL ALMARAZ**  
malmaraz@newmarklsb.com  
O: 405.879.4771

**LOUIS ALMARAZ**  
lalmaraz@newmarklsb.com  
O: 405.879.4772

204 N. Robinson, Ste 700 OKC, OK, 73102  
110 W. 7th, Ste 2600 Tulsa, OK, 74119

for more information, visit us at  
**newmarklsb.com**

The information contained herein was obtained from sources believed reliable; however, Newmark Grubb Levy Strange Beffort makes no guarantees, warranties or representations as to the completeness or accuracy thereof. The presentation of this property is submitted subject to errors, omissions, change of price or conditions prior to sale or lease, or withdrawal without notice. Independently Owned and Operated.



## TENANT MIX

Suite	SF	Tenant
2701	72,248	Buy For Less
2703	460	Caramba
2705	850	Econo-Wise
2707	480	Salon
2709	960	Order Express
2711	12,000	Dollar Tree
2713	600	Storage
2715		Fuel
2717	5,265	AT&T
2719	1,272	Cell Phone Donkey
2729	18,000	dd's Discounts
2737-1	1,420	Sun Loan Company
2737-2	1,825	Goodwill Industries
2737-3	1,800	Fade N Up Barbershop
2737-4	1,400	Mexican Restaurant
<b>2741</b>	<b>2,800</b>	<b>Available</b>
2801	10,077	Dollar Tree
2805	27,000	Sears Hometown
2809	40,070	Locke Supply

## DEMOGRAPHIC SNAPSHOT (W/IN 3 MI.)

2018 Median household income	\$32,600
2018 Population	88,486
2023 Population estimated at	93,047
2018 Median age	30.3
2018 Total households	29,370

## PROPERTY OVERVIEW

Vibrant, growing shopping center within 1/2 mile of I-44. Located less than 5 minutes to I-40, I-240, and Will Rogers Airport. The property enjoys strong, long-term tenants.

## PROPERTY DETAILS

Available SF	1,800
Lease Rate	\$21.25/SF
NNN	\$3.25/SF
Building Size	271,308

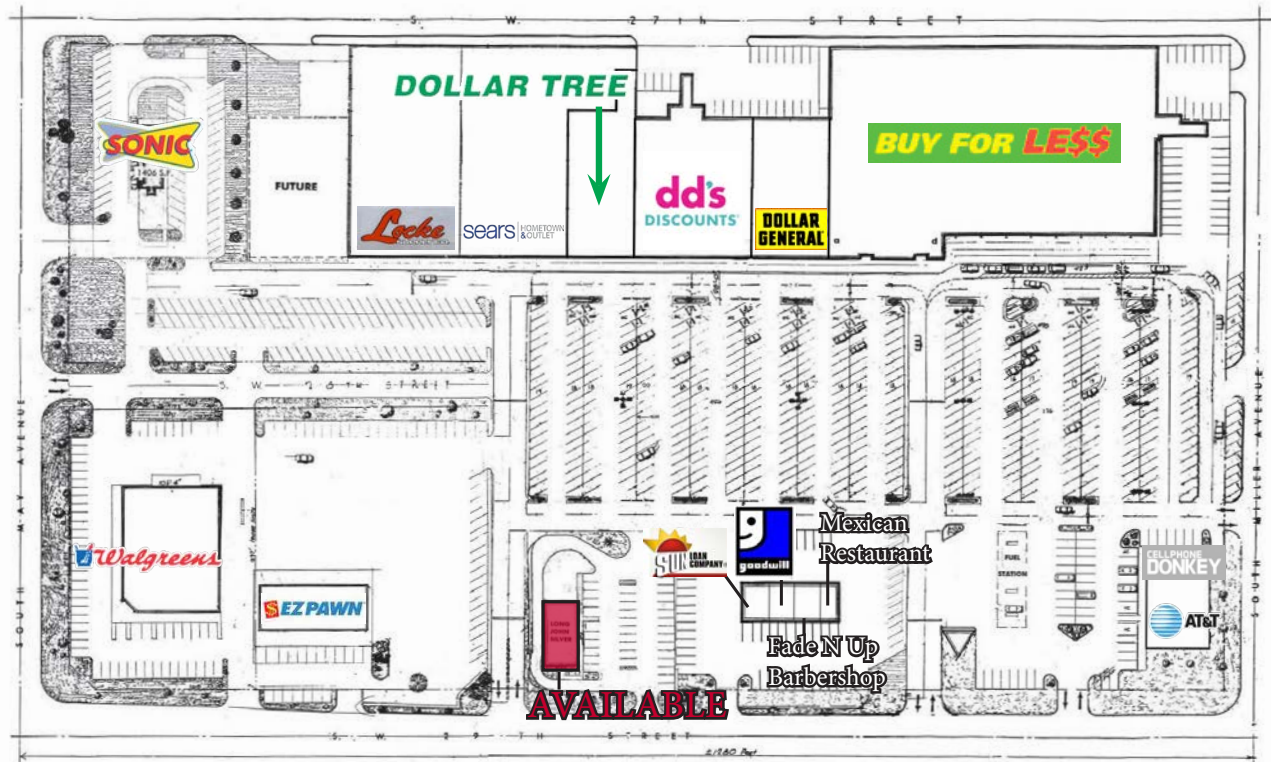

2701-2835 SW 29th Street, Oklahoma City, OK 73119 | FOR LEASE

