



FRATES INSURANCE
RISK MANAGEMENT

MEMORIAL PROFESSIONAL BUILDING | FOR LEASE

13439 BROADWAY EXTENSION, OKLAHOMA CITY, OK

BRENT CONWAY

bconway@newmarklsb.com

O: 405.208.8636 C: 405.850.2442

 **NEWMARK GRUBB**
LEVY STRANGE BEFFORT

13439 BROADWAY EXTENSION

2nd Floor
17,421 SF

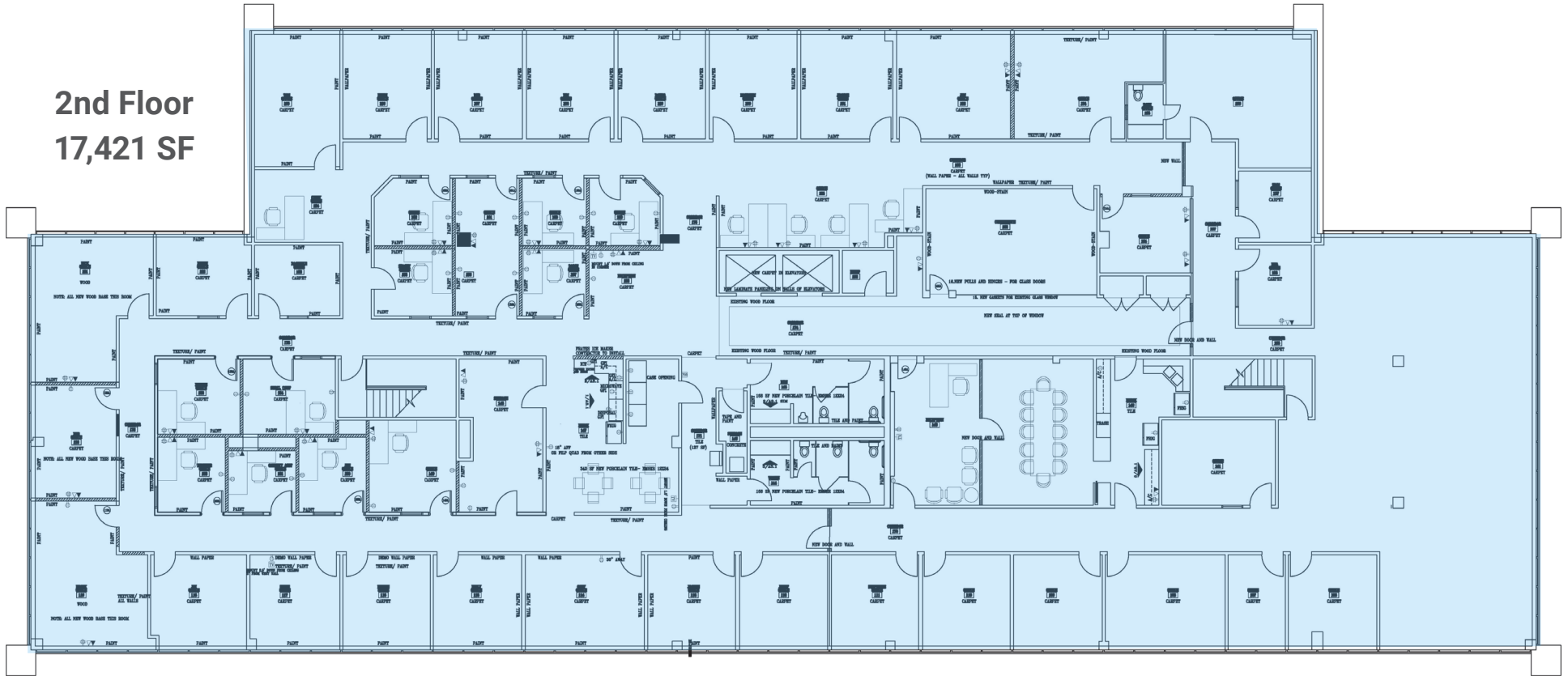

PROPERTY OVERVIEW

Memorial Professional is a headquarter quality building situated along Broadway Extension in North Oklahoma City. The building has excellent visibility from Broadway Extension, with convenient access to the Kilpatrick Turnpike, and the metropolitan area.

PROPERTY DETAILS

Price/SF	\$19.50 / SF FSG
Available SF	17,421 SF
Parking	Available

PROPERTY HIGHLIGHTS

Newly renovated
Windowed offices with expansive views
Well-designed executive spaces



204 N. Robinson, Ste 700 OKC, OK, 73102 | for more information, visit us at
110 W. 7th, Ste 2600 Tulsa, OK, 74119 | **NEWMARKLSB.COM**

The information contained herein was obtained from sources believed reliable; however, Newmark Grubb Levy Strange Beffort makes no guarantees, warranties or representations as to the completeness or accuracy thereof. The presentation of this property is submitted subject to errors, omissions, change of price or conditions prior to sale or lease, or withdrawal without notice. Independently Owned and Operated.