



FOR LEASE

9821 S MAY AVENUE, OKLAHOMA CITY, OK 73159

**VICKI KNOTTS**

[vknotts@newmarklsb.com](mailto:vknotts@newmarklsb.com)

O: 405.879.4761

**BEN KNOTTS**

[bknotts@newmarklsb.com](mailto:bknotts@newmarklsb.com)

O: 405.879.4766

**NEWMARK GRUBB**  
LEVY STRANGE BEFFORT



# FOR LEASE/9821 S MAY AVENUE, OKLAHOMA CITY, OK 73159

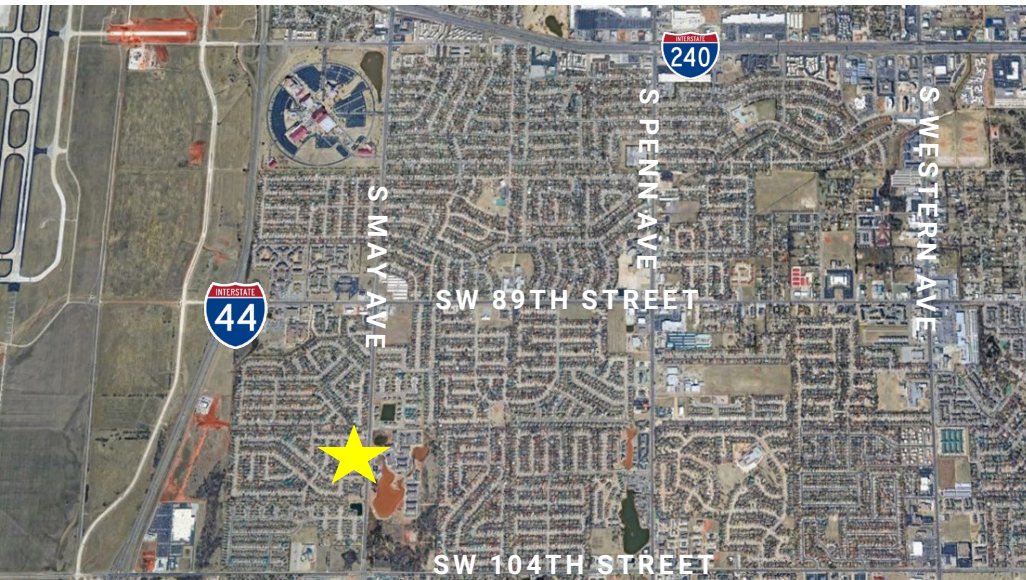

## PROPERTY OVERVIEW

Located on S May Avenue between Penn Avenue and I-44 in a medical development which includes Southwest Eye & Surgery Center, Weir Laser, and Retina Consultants of Oklahoma. The space includes 4,500 square feet of clinical space with a large lobby, eight exam rooms, two bathrooms, labs, several offices and surgical suite. The smaller space is in shell condition and can be custom built to tenant's needs. Both suites have private entrances and abundant glass.

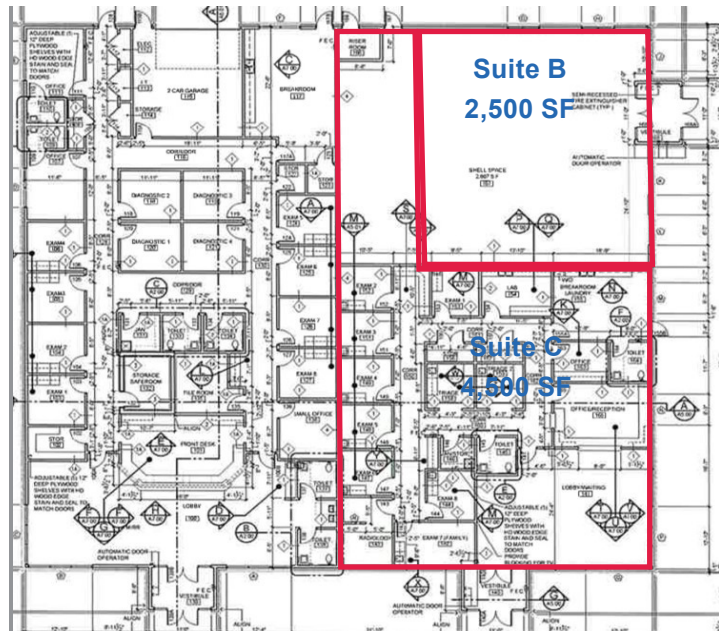

## PROPERTY DETAILS

Available	7,000 SF
Suite B: 2,500 SF	\$18.50/SF
Suite C: 4,500 SF	\$23.00/SF
Lease Type	Modified Gross
Lease Term	3 - 5 Years

## PROPERTY HIGHLIGHTS

- Drive parking
- Surrounding medical
- Street lamps in parking lot
- Monument signage
- Immediate access to I-44
- Convenient to fast food & restaurants



204 N. Robinson, Ste 700 OKC, OK, 73102 | for more information, visit us at  
110 W. 7th, Ste 2600 Tulsa, OK, 74119 | **NEWMARKLSB.COM**

The information contained herein was obtained from sources believed reliable; however, Newmark Grubb Levy Strange Beffort makes no guarantees, warranties or representations as to the completeness or accuracy thereof. The presentation of this property is submitted subject to errors, omissions, change of price or conditions prior to sale or lease, or withdrawal without notice. Independently Owned and Operated.