



13144 N MAY AVENUE | FOR LEASE

OKLAHOMA CITY, OK 73120

**JOHN COHLMIA**

[jcohlmia@newmarkrp.com](mailto:jcohlmia@newmarkrp.com)

O: 405.879.4773 C: 405.620.1999

**NEWMARK**  
ROBINSON PARK



# 13144 N MAY AVENUE / FOR LEASE

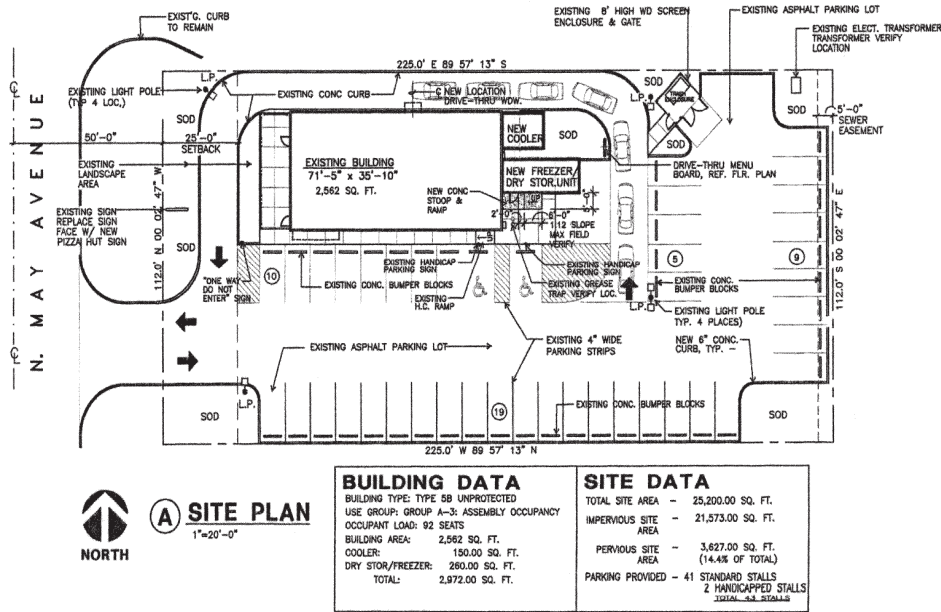

## DETAILS

Available SF	2,592 SF
Lease Rate	\$7,000/Month (as is)
Lease Type	NNN
Building Size	2,592 SF

## HIGHLIGHTS

Located in the "Quail Springs" corridor
Fronts on May Ave., just South of Memorial Rd.
Freestanding building with drive-thru capabilities
Constructed in 1998

## SNAPSHOT

<b>Population</b> 3 mi Radius 71,253	<b>Median HH Income</b> 3 mi Radius \$62,810	<b>Daytime Population</b> 3 mi Radius 44,192	<b>Traffic Count</b> N May Ave. 21,022 VPD