



3617 S COUNCIL ROAD | FOR LEASE
OKLAHOMA CITY, OK 73179

JIM KAREY
jkarey@newmarkrp.com
O: 405.879.4774 C: 405.203.1303

NEWMARK
ROBINSON PARK

3617 S COUNCIL ROAD | FOR LEASE

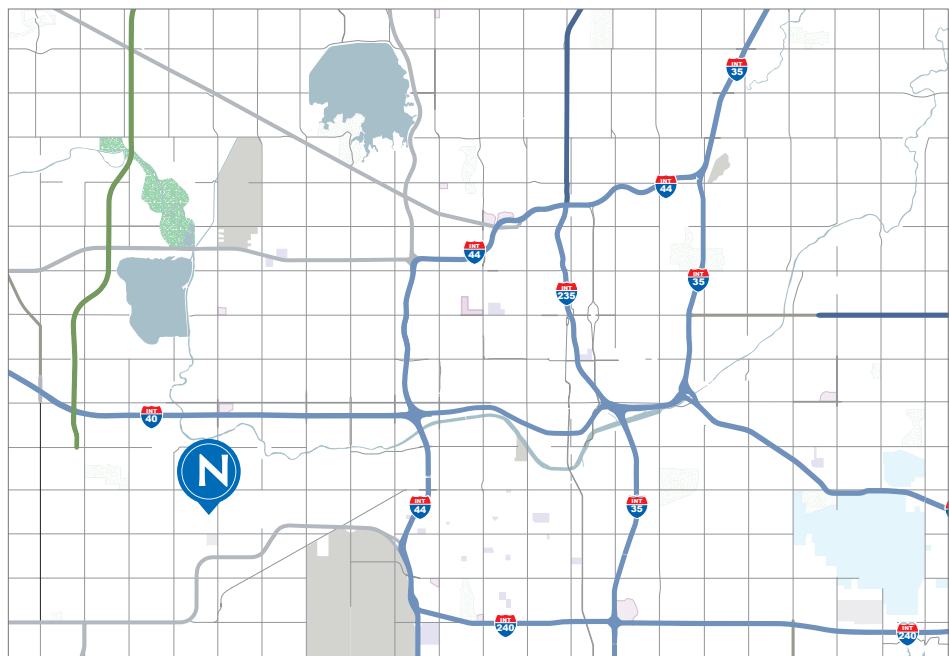

PROPERTY OVERVIEW

Great location with easy access to Highway 152, Interstate 40, and the Kilpatrick Turnpike. Constructed in 2020, there are multiple bays available, each with 1,984 square feet of space. Each bay includes 250 square feet of air conditioned office space with one space heater in the warehouse area.

Water is included, however, the tenant is responsible for electric and gas.

DETAILS

Available Bay Size	1,984 SF
Lease Rate per Bay	\$1,900 / Month
Building Size	11,940 SF
Year Built	2020
Zoning	PUD-757

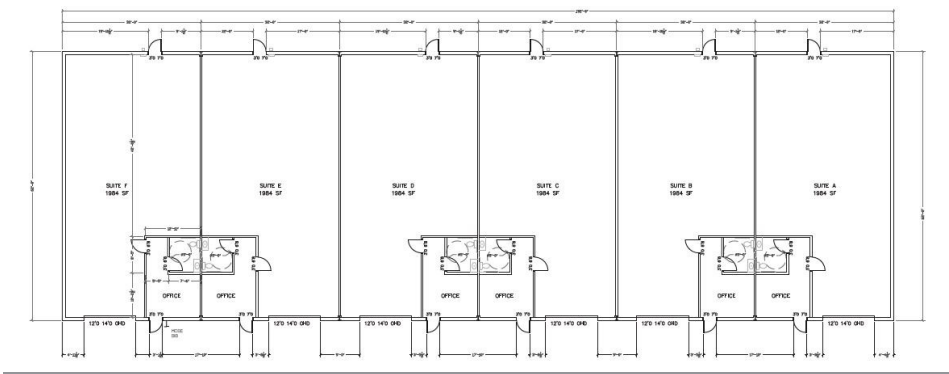

PROPERTY HIGHLIGHTS

HVAC: office is air conditioned | warehouse has 1 space heater

Office: 250 SF | 1 office and 1 restroom

Grade Level Door: 1 - 12' x 14'

Clear Height: 15'

Electrical: 3-Phase, 200 amps, 220 volts